



The "3 in 1" innovation: Waterproofing, tile fixing and de-coupling

weber.xerm 844

Highly reactive waterproofing
and adhesive for tiles and slabs



**we
care**



SAINT-GOBAIN
350



weber
SAINT-GOBAIN

Water has no place

Waterproofing, tile fixing and de-coupling with **weber.xerm 844**



The innovative space distancers areas the best guarantee for controlled layer thickness of waterproofing and tile laying with **weber.therm 844** in one operation.

weber.xerm 844 –

one product –
three applications –
Numerous benefits



Tile layers carry out many operations, for ex. priming, waterproofing, de-coupling, application of tile adhesives and grout mortars.

For this reason they must handle and have a wide product range on stock all the time. Some of the products can be now replaced by a unique solution.

weber.xerm 844 is a highly reactive waterproofing and adhesive for tiles and slabs which allows three applications: it can be used as watertight reactive waterproofing under tiles and slabs and as high performance tile adhesive. On top ceramic tiles or slabs can be de-coupled from critical substrates.

Where no water penetrates, no damage will happen.

This innovative professional solution saves time and simplifies the working schedule process. Not only less products are needed on stocks, but also the risk with unexperienced to use a wrong product is reduced. Besides these benefits

weber.xerm 844 has outstanding features, like a quick drying independent from weather conditions. Water cannot penetrate into the hardened waterproofing layer and typical humidity damages like efflorescence or spalling due to frost are avoided from the start.

The waterproofing system for balconies and terraces

Built-up: innovative or conventional

weber.xerm 844

10
YEAR
MATERIAL
WARRANTY

Drawing for innovative application with weber.sys Abdicht- and Verlegeglätter

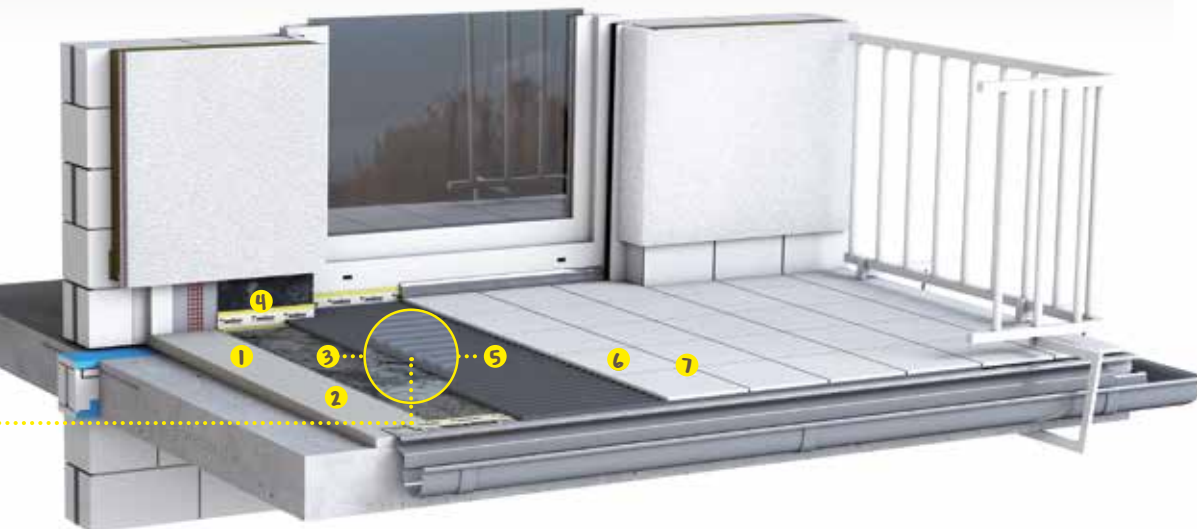

1. Screed with slope
2. Primer **weber.prim 801**
3. Scratch layer
4. Sealing tape **weber.tec 828**
5. Waterproofing layer and tile adhesive **weber.xerm 844**
6. Ceramic tiles (for ex. 60 x 60 cm porcelain tiles*)
7. Grout mortar **weber.fug 877**

Drawing for conventional application in 2 waterproofing layers



1. Screed with slope
2. Primer **weber.prim 801**
3. First waterproofing **weber.xerm 844**
4. Sealing tape **weber.tec 828**
5. Second waterproofing layer **weber.xerm 844**
6. Tile fixing layer **weber.xerm 844**
7. Ceramic tiles (for ex. 60 x 60 cm porcelain tiles*)
8. Grout mortar **weber.fug 877**

* with low water absorption < 0,5% (EN 14411) - upon approval tile size up to 100 x 100 cm is allowed and a 10 year-material warranty can be provided.

For each weather

For a reliable planning with the right system



After 4 hours

the fresh fixed covering withstands all weather conditions...

weber.xerm 844 is suitable for solid-bonded waterproofing under ceramic tiles and slabs in bathrooms, wet-duty rooms, balconies and swimming pools. It quickly dries also under air exclusion and is after drying watertight resistant to frost, sulphate, UV-rays and ageing.

The weather cannot be planned... the right system can!

Due to the reactive hardening and the frost resistance the product ideally suits the tile laying on balconies and terraces. Even in case of large-size tiles its drying process is so far ahead after 4 hours that a temperature fall in the night or a heavy rain cannot damage the applied material. Hence the planning schedule of tile layers is more flexible, since it is nearly independent from weather conditions, especially for outdoor works.



More performance and more versatile

Also suitable for large-size tiles



It follows that **weber.xerm 844** with **weber.sys Abdicht- and Verlegeglätter** on the waterproofed surface. The material dries as waterproofing as well as tile adhesive without cracks and free of internal tensions.

Thanks to its quick and weather-independent hardening, and its creamy consistency **weber.xerm 844** offers highest reliability against humidity damages in case of building parts subject to high water load.

The trowel **weber.sys Abdicht- and Verlegeglätter**

Thanks to its construction this innovative tool gives the applied material the right distribution and the right form and hence guarantees uniform and right layer thickness all over the surface. It enables to use **weber.xerm 844** in one go for waterproofing and for tile laying.

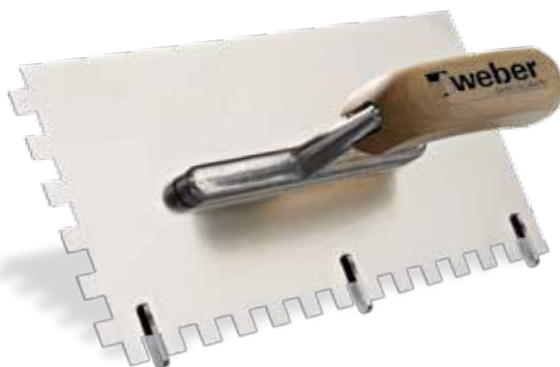

Your benefits:

- highly flexible and watertight
- weather-independent, quick drying through reactive setting, even under air exclusion
- avoids efflorescence and frost damages
- optimal for balconies, terraces and critical substrates
- after 4 hours tiles can be grouted
- also for large-size porcelain tiles

Acoustic and de-coupling layer

Made by yourselves

Photos 1-3:

1. + 3. Extremely thin and withstanding solid-bonded waterproofing

2. On mixed substrates the system enables a reliable tile fixing

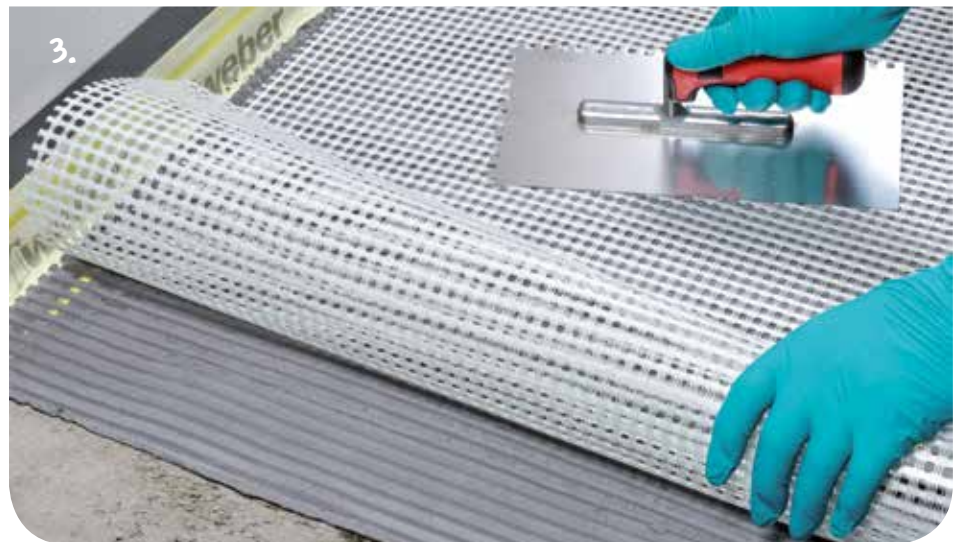
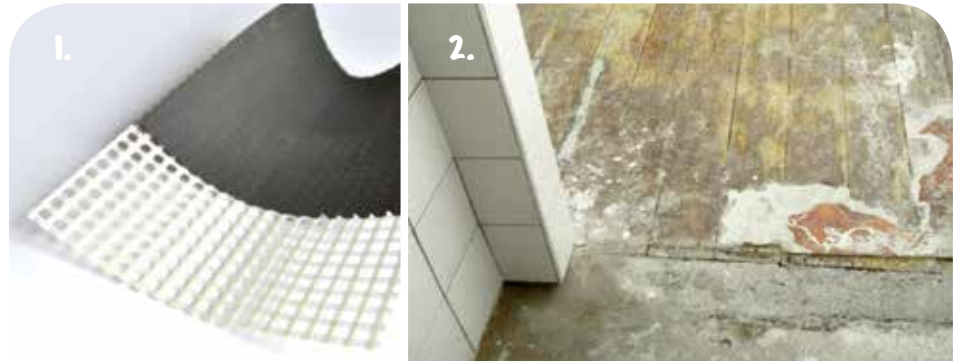

De-coupling with weber.xerm 844 means:

- floor coverings are de-coupled with minimal height (1 mm)
- moisture-sensitive substrates are protected from humidity
- an optimal use for critical substrates like young cement screeds, concrete, timber or mixed substrates is given
- footfall sound absorption is reduced up to 5 decibels
- a reliable crack-bridging is provided
- internal tensions of whole system are minimized via high take-over of shear force
- traffic loads are compensated
- hollow sounds like de-coupling membranes in rolls are excluded

weber.xerm 844 can much more. A professional tile layer can de-couple tiles and slabs and at the same time reduce the footfall sound on floors. He can perform this de-coupling layer by himself whereas he lays the mesh

weber.sys 835. The de-coupling is also possible on critical substrates, like young cement screeds etc.; in that case tiles can be laid in the time between 3rd and 7th day after screed application.

A further benefit: due to the full surface embedment of the mesh within the tile adhesive layer hollow sounds like de-coupling membranes will be excluded.

The right solution for each challenge

The optimal solution for each performance level and built-up

PERFORMANCE LEVEL 1

Critical substrate

For ex. anhydrite screeds, concrete (> 28 days), young cement screeds (3 – 7 days old), old tiles

Primer:

weber.prim 801 or **weber.prim 803** (depending upon substrate porosity)

1 mm de-coupling layer with **weber.xerm 844**

Solid-bonded waterproofing: 1.5 bar

Crack-bridging: 1 mm

Resistance to mechanical load: 75 KN/m²

Tile fixing with **weber.xerm 844**

Improvement of acoustic insulation: up to 5 decibels
(alternative: flexible tile adhesive of class S1 without acoustic improvement)

Ceramic tiles or natural stones

Grout mortar

weber.fug 875 F or **weber.fug 877**



PERFORMANCE LEVEL 2

Critical substrate

Mixed substrates, wooden substrates (chipboards or OSB boards), timber plankings

Mixed substrates with old setting or tension cracks or substrates covered with composite materials and hence different thermal expansion coefficient

Primer

weber.prim 801 or **weber.prim 803** (depending upon substrate porosity)

1 mm de-coupling layer with **weber.xerm 844** and **weber.sys 835**

Solid-bonded waterproofing: 1.5 bar

Crack-bridging: 1 mm

Resistance to mechanical load: 75 KN/m²

Tile fixing with **weber.xerm 844**

Improvement of acoustic insulation: up to 5 decibels
(alternative: flexible tile adhesive of class S1 without acoustic improvement)

Ceramic tiles or natural stones

Grout mortar

weber.fug 875 F or **weber.fug 877**

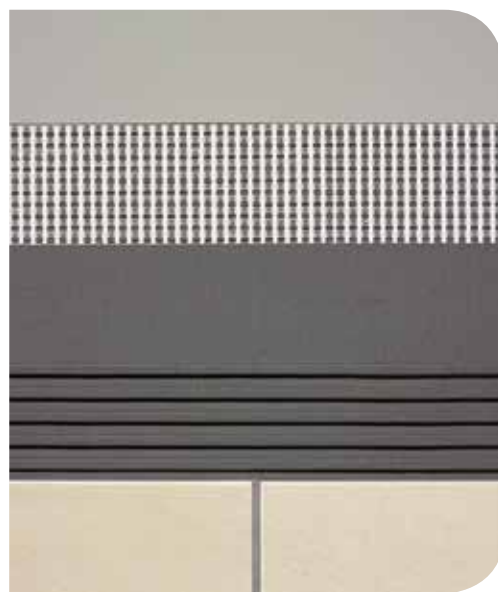

PERFORMANCE LEVEL 3

Critical substrate

Substrates like levels 1 and 2, but with request for a supplementary floor acoustic insulation

Primer

weber.prim 801 or **weber.prim 803** (depending upon substrate porosity)

Glue for fixing acoustic boards with for ex. **weber.xerm 844**

weber.sys 830 (acoustic and de-coupling boards)

Improvement of acoustic insulation: up to 14 decibels (in combination with **weber.xerm 844**)

Waterproofing performance: 1.5 bar

Crack-bridging: >1 mm

Tile fixing with for ex. **weber.xerm 844**

Alternative: use of S1 flexible tile adhesive

Ceramic tiles or natural stones

Grout mortar

weber.fug 875 F or **weber.fug 877**



At **weber**, we believe that the most important in the building industry is to **care** about **people** and their **environment**



Well-being

We care

For the well-being of people.



Empathy

We care

We care

about what matters to people.



Long-lasting

We care

about our long-term responsibility.

Saint-Gobain Weber GmbH
Schanzenstraße 84
40549 Düsseldorf
sg-weber.de

 **weber**
SAINT-GOBAIN